

SECURITY OPTIONS

Mounting Collars & Angles

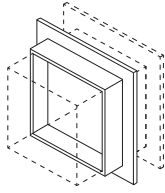

OPTION 10

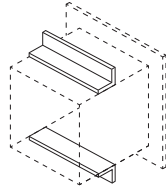

OPTION 11

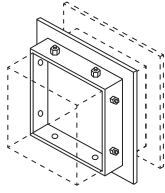

OPTION 12

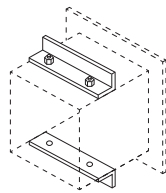

OPTION 13

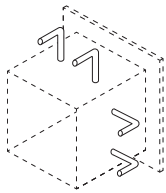

OPTION 14

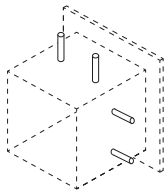

OPTION 15

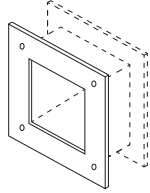

OPTION 16

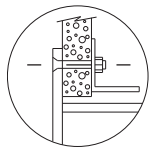

OPTION 17

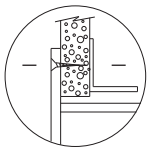

OPTION 18

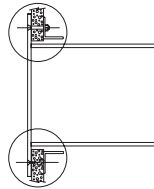

- **Option 10:** Assembled outer rear 1-1/4" × 1-1/4" × 3/16" loose angle collar for welding
- **Option 11:** Assembled outer rear 1-1/4" × 1-1/4" × 3/16" loose angles for welding
- **Option 12:** Separate outer rear 1-1/4" × 1-1/4" × 3/16" loose angle collar for bolting
- **Option 13:** Separate outer rear 1-1/4" × 1-1/4" × 3/16" loose angles for bolting

Fastening Methods

- **Option 14:** Masonry Tabs - size, length and spacing as required
- **Option 15:** Masonry Rods - size, length and spacing as required
- **Option 16:** Matching rear plate with weld nuts for room to room or door grille transfer
- **Option 17:** Rear angle ring with nutsert for bolting
- **Option 18:** Countersunk screw holes in face for tamper proof screws

Damper and Air Deflection Options

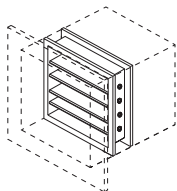

OPTION 20

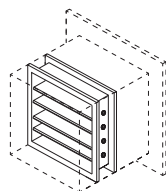

OPTION 21

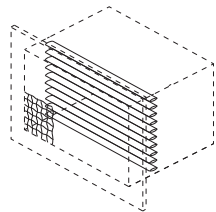

OPTION 22

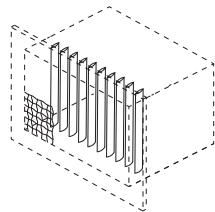

OPTION 23

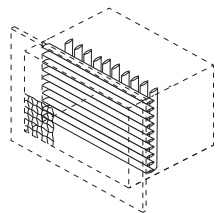

OPTION 24

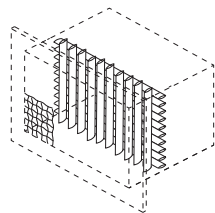

OPTION 25

- **Option 20:** Opposed Blade Damper front operated
- **Option 21:** Opposed Blade Damper rear operated
- **Option 22:** Single deflection airfoil blades, bars parallel to longest dimension
- **Option 23:** Single deflection airfoil blades, bars parallel to shortest dimension
- **Option 24:** Double deflection airfoil blades, front bars parallel to longest dimension with rear blades opposite
- **Option 25:** Double deflection airfoil blades, front bars parallel to shortest dimension with rear blades opposite
- **Note:** Options 22, 23, 24 and 25 include option 40 (10 gauge #2 mesh woven wire)

SECURITY OPTIONS

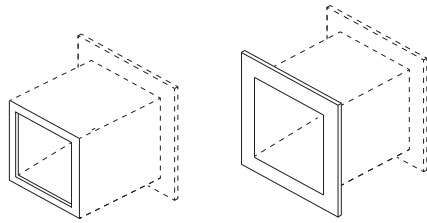

OPTION 30

OPTION 31

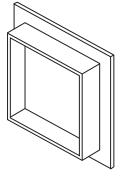

OPTION FF

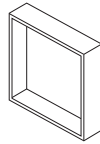

OPTION IF

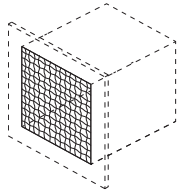

OPTION 40

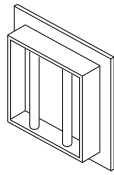

OPTION 41
Shown in FF

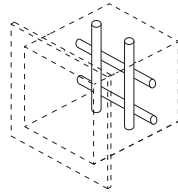

OPTION 42
Shown in sleeve

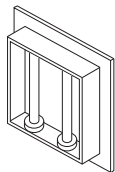

OPTION 43
Shown in IF

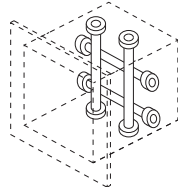

OPTION 44
Shown in sleeve

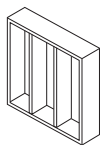

OPTION 20
Shown in IF

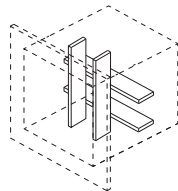

OPTION 46
Shown in sleeve

Sleeve Options

- Option 30: Bent in rear flange available all sleeves
- Option 31: Bent out rear flange available all sleeves

Barrier Frame Styles

- Option FF: Flange Frame, 2-1/2" x 2-1/2" x 1/4" angle frame
- Option IF: Interior Frame, Separate inner 2-1/2 x 3/8" flat steel frame. Can be used with barrier designs below

Barrier Design Options

- Option 40: 10 gauge #2 mesh woven wire
- Option 41: Standard round 1/2", 3/4" or 1" diameter bars welded to sleeve max. 6" vertical
- Option 42: Standard round 1/2", 3/4" or 1" diameter bars welded to sleeve at all crossings. Max. 6" vertical, 12" horizontal
- Option 43: C-61 Rockwell heat treated 1/2", 3/4" or 1" diameter bars in sockets. Maximum 6" vertical
- Option 44: C-61 Rockwell heat treated 1/2", 3/4" or 1" diameter bars in sockets. Maximum 6" vertical, 12" horizontal
- Option 45: 2-1/2" x 3/8" steel bars on max. 6" vertical centers welded to center of sleeve
- Option 46: 2-1/2" x 3/8" vertical and horizontal steel bars on max. 6" vertical, 12" horizontal centers, welded on center of sleeve and at crossings

Accessories

- Tamper Proof Screws - #10x1-1/2" sheet metal screws
Option F: Torx Center Pin
FSS: Torx Center Pin Stainless Steel

