

2" Round Collar

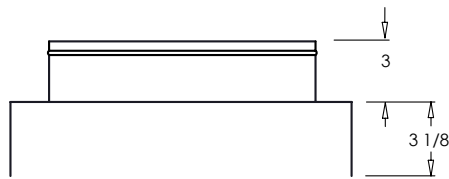

3" Round Collar

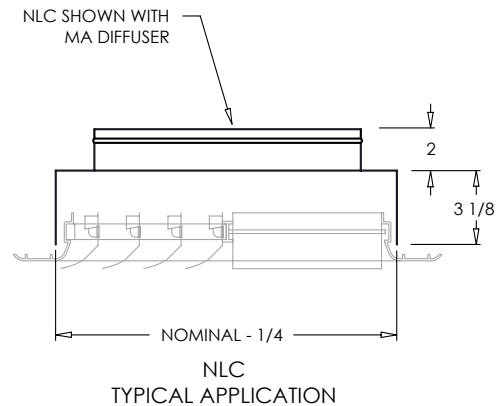

**Standard Features:**

- Square to round ADC compliant 2" No Labor Collar with roll formed retention bead
- Collar sizes available in 6" through to 24" (must be equal to or smaller than box size)
- Box sizes available in 6"x6" through 24"x24"
- NLC is listed under "Standard Features" or "Options" section on compatible product submittals
- Can be field installed
- Mill finish

**Options:**

3" collar (available on select products-see T-Bar product pages for availability)

**Finishes:**

STANDARD COLORS

- Mill Finish

**Additional Information:**

**Submittal Notes**

Project / Location:	
Engineer:	
Architect:	
Contractor:	